

Dimensions

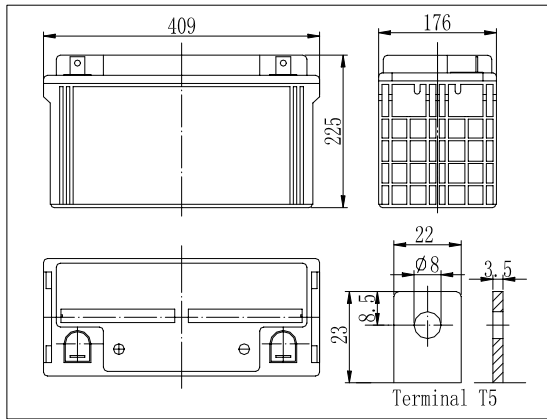

Specifications

Nominal Voltage	12 V	
Capacity(10HR, 25°C)	120 Ah	
Dimension	Length	409mm (16.1inch)
	Width	176mm (6.93inch)
	Height	225mm (8.86inch)
	Total Height	225mm (8.86inch)
Approx. Weight	37.5kg (82.7lbs)	
Internal resistance (Fully charged, 25°C)	Approx.4m Ω	
Capacity affected by temperature (10HR)	40°C	102%
	25°C	100%
	0°C	85%
	-15°C	65%
Self-discharge (25°C)	3 month	Remaining Capacity: 91%
	6 month	Remaining Capacity: 82%
	12 month	Remaining Capacity: 65%
Nominal operating temperature	25°C ± 3°C (77°F ± 5°F)	
Operating temperature range	-15°C ~ 50°C (5°F ~ 122°F)	
Float charging voltage(25°C)	13.38 to 13.80V	
Cyclic charging voltage(25°C)	14.40 to 15.00V	
Maximum charging current	36A	
Terminal material	Copper	
Maximum discharge current	960A(5 sec.)	

- ◆ Absorbent glass mat technology;
- ◆ Recognized by UL & CE;
- ◆ Flame retardant ABS container (UL94V-0 / 94 V-2)

Charging Characteristics(25°C)

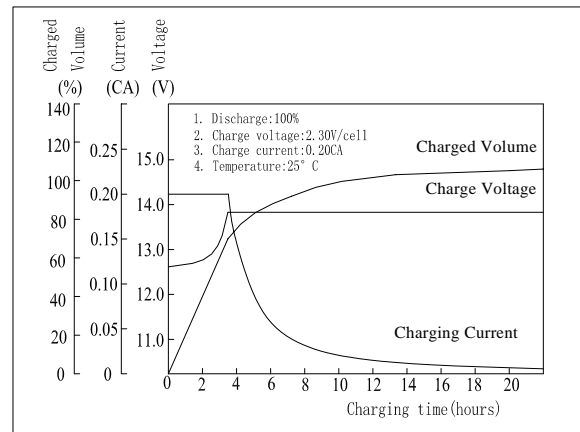

Cycle Life(25°C)

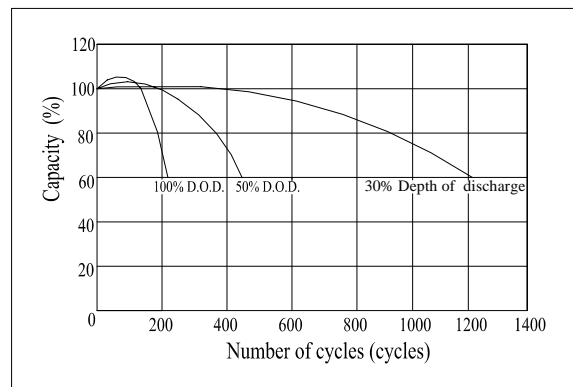

Note: Floating life designed for 10 years at 25°C

Constant Current Discharge Characteristics (A, 25°C)

F.V/TIME	5min	10min	15min	30min	60min	2h	3h	5h	8h	10h	20h
9.60V	370	250	210	130	78.0	43.8	31.0	21.9	14.6	12.2	6.35
10.2V	352	238	202	125	74.9	43.2	30.5	21.6	14.5	12.1	6.35
10.8V	331	224	192	119	71.2	42.3	29.9	21.2	14.4	12.0	6.20

Constant Power Discharge Characteristics (Watt, 25°C)

F.V/TIME	5min	10min	15min	30min	60min	2h	3h	5h	8h	10h	20h
9.60V	3885	2700	2306	1459	889	508	365	259	175	145	76.2
10.2V	3696	2570	2218	1403	854	500	359	255	174	144	76.2
10.8V	3476	2419	2108	1335	812	490	352	251	173	144	74.4